

Cemento



Design Guide

for lightweight Cimento®

Cemento edge guide

The overall price of our lightweight panels can vary depending on what edge is right for the job. As a general rule, edges 01 - 06 are included in our standard pricing. Edges 07 - 12 will incur additional costs. For a detailed quote, please send design drawings to enquiries@cemento.co.uk

Price breakdown

- £ Included in our standard pricing
- ££ Minimal increase in cost
- £££ Premium price range
- * Plus material cost

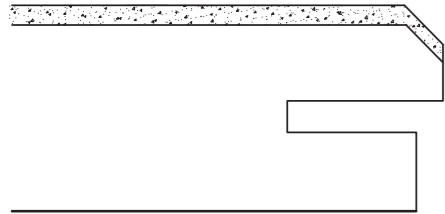

E.01
Standard Chamfered Edge
£

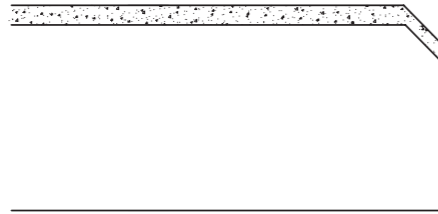

E.02
Square Chamfered Edge
£

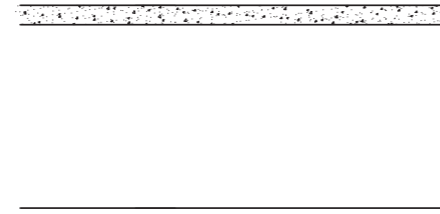

E.03
Square Edge
£

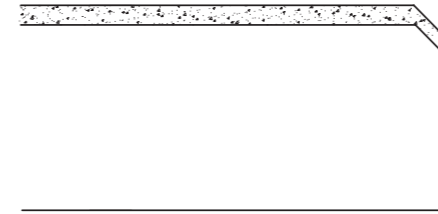

E.07
Painted to match Chamfered Edge
££

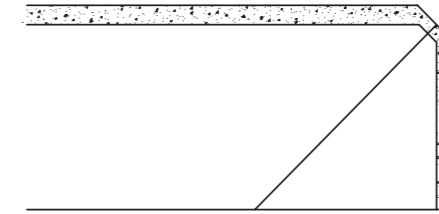

E.08
Finished Edge
£££

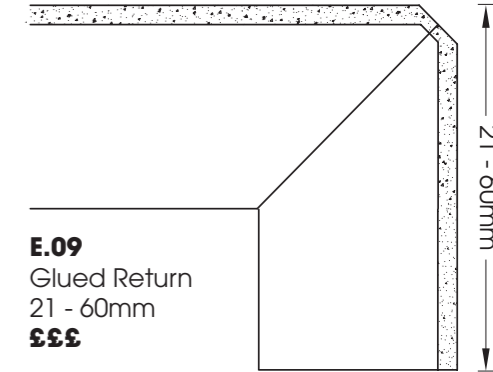

E.09
Glued Return
21 - 60mm
£££

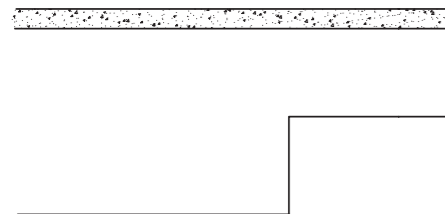

E.04
Scribe Edge
£

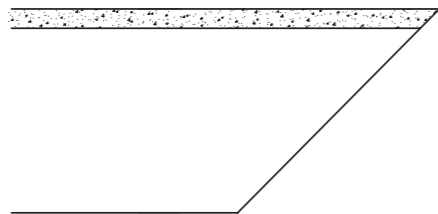

E.05
Mitred Cut Edge
£

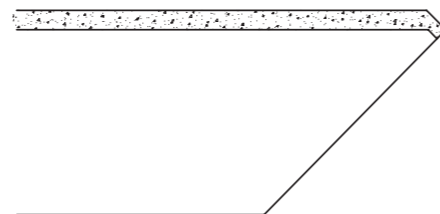

E.06
Chamfered & Mitred Cut Edge
£

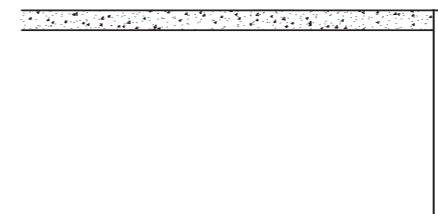

E.10
PVC Edge
££

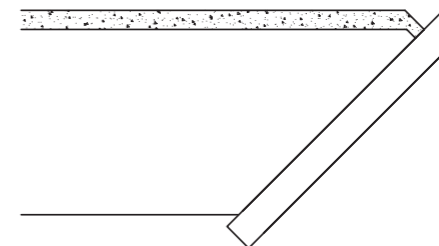

E.11
Chamfered & Mitred Cut Edge
with 3mm Stainless Steel Trim
£££*

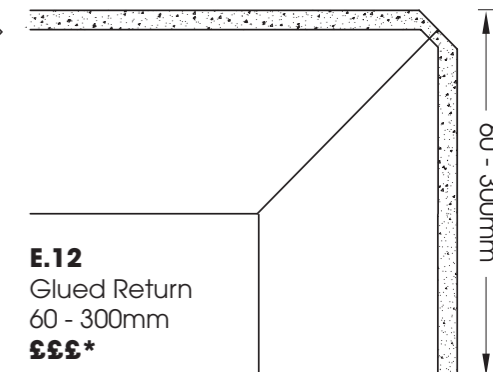

E.12
Glued Return
60 - 300mm
£££*

Cemento fixing systems

- A** MDF Split Baton - 23mm cavity
- B** Z-bar - 10mm cavity
- C** Sai Clip - 15 - 40 mm cavity
- D** Face Fixed Screw - through Ando Hole
- E** Adhesive - 3mm cavity
- F** Nvelope - 30 - 250 mm cavity

	MDF	HPL	FBC	PanPVC	PLY	External Use
A	●	X	X	●	●	X
B	●	X	X	●	●	X
C	●	X	X	X	●	X
D	●	X	X	X	●	●
E	●	●	X	●	●	●
F	X	X	●	X	X	●

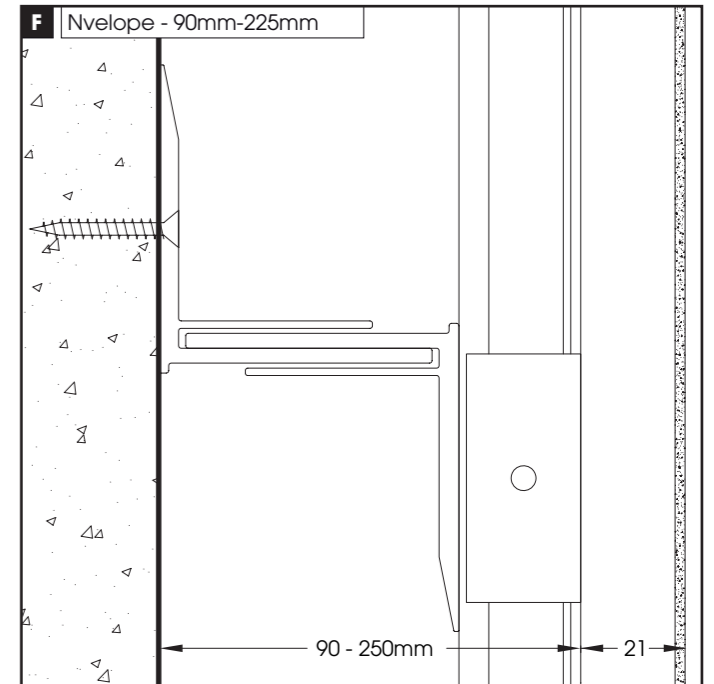
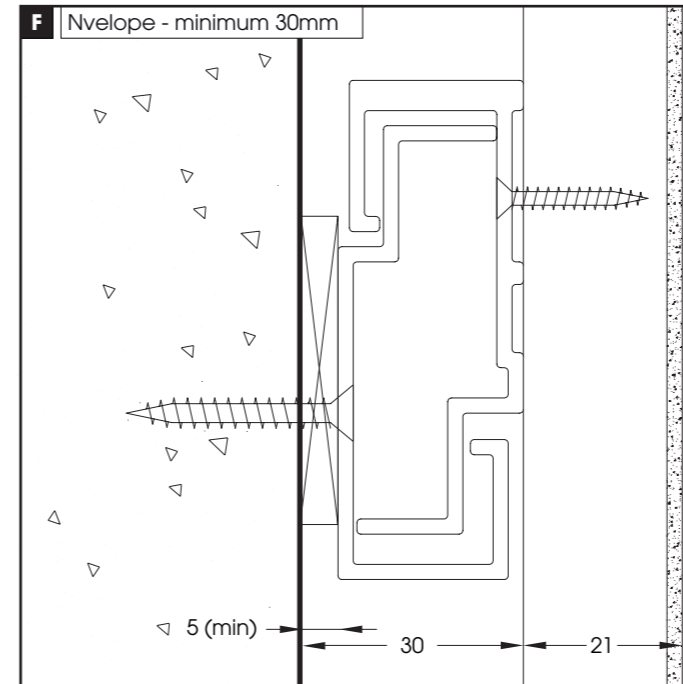
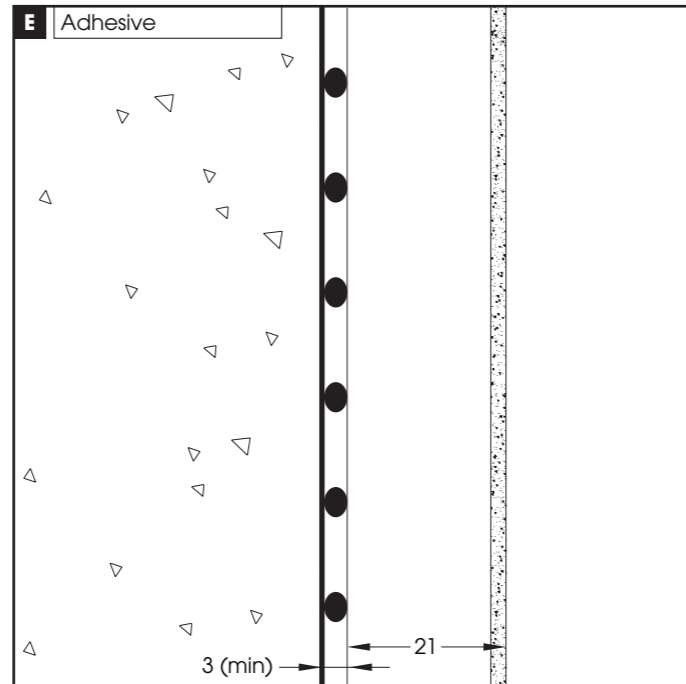
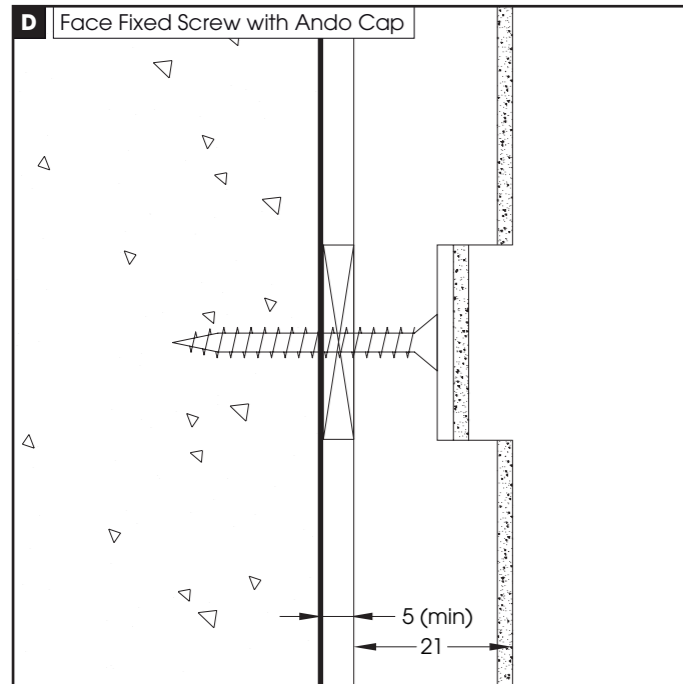
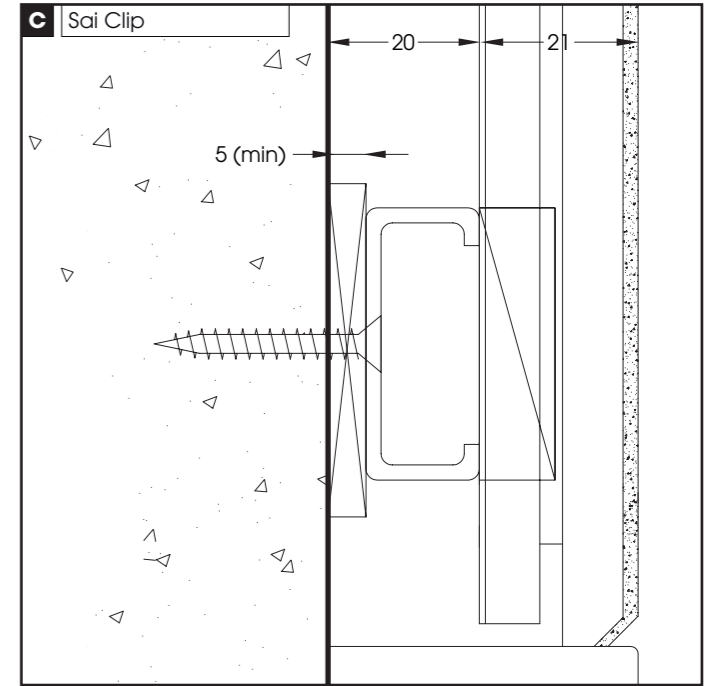
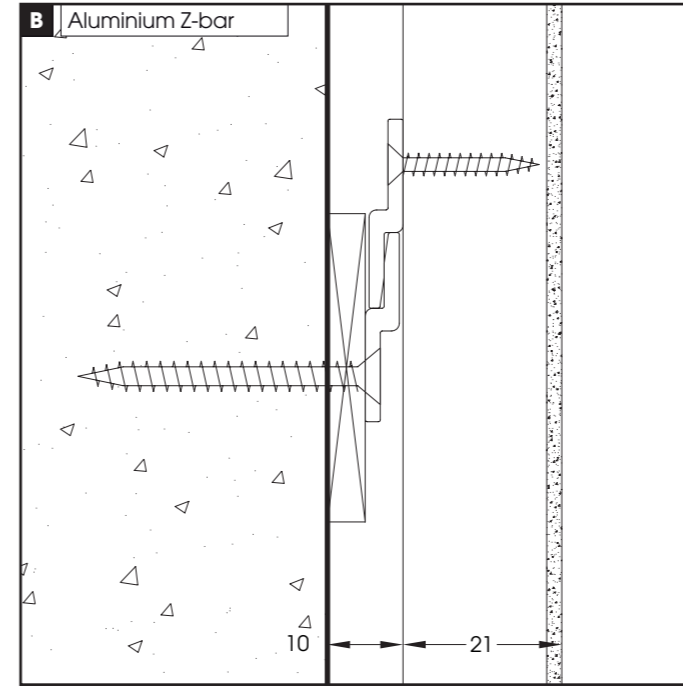
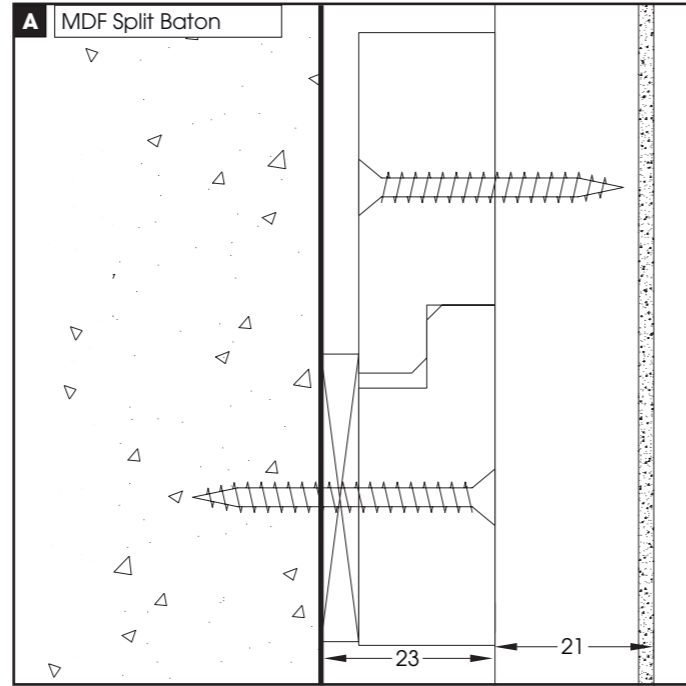

Build your **internal** wall

The following diagrams depict panel joints for internal wall panelling or joinery. Go on, have some fun. We encourage you to cut along the dashed lines and have a play with the design elements.

Scale 1:1
Substrate: 19mm MFD

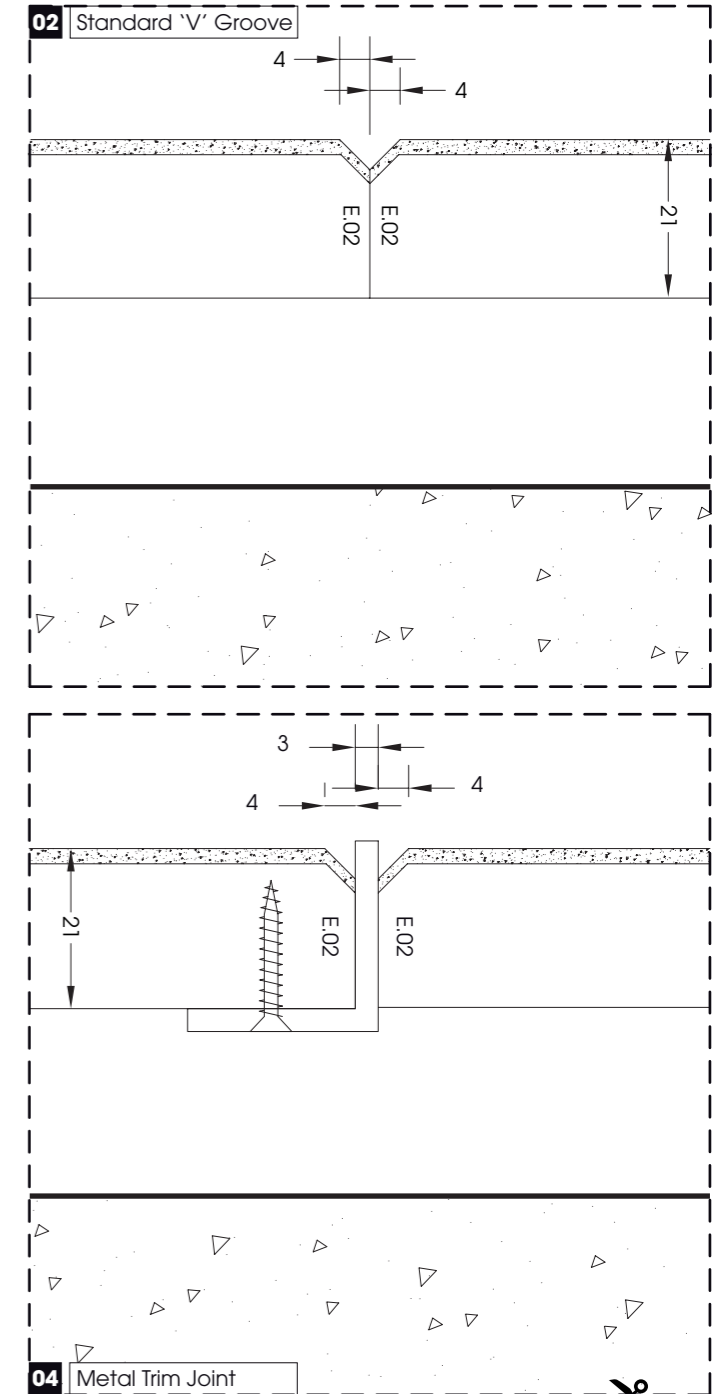
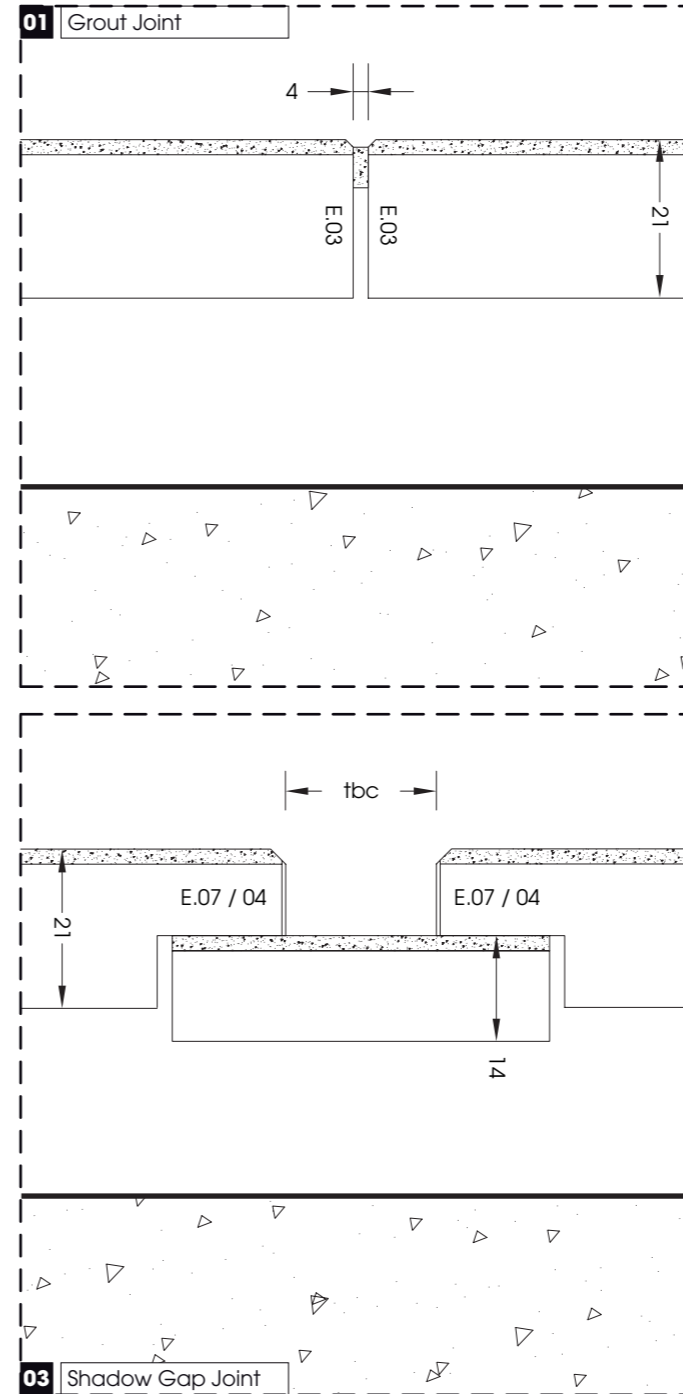

05 Overlap Corner

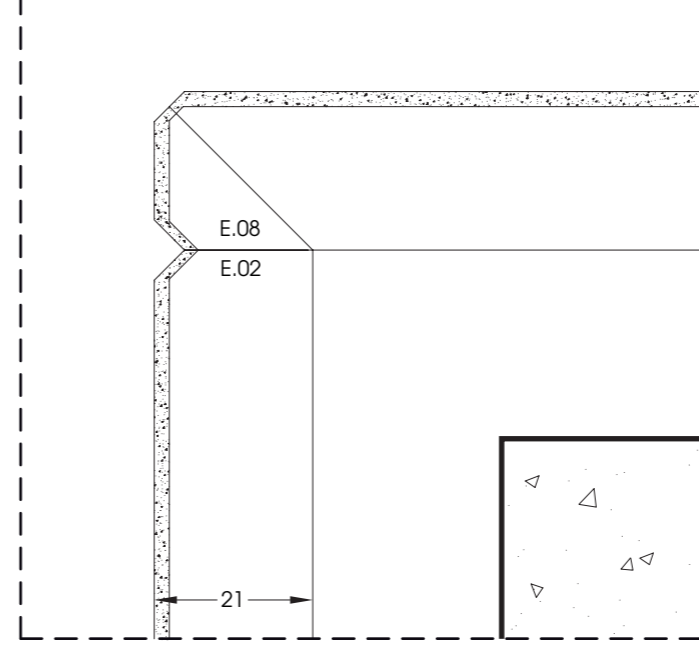

06 Dressed Corner

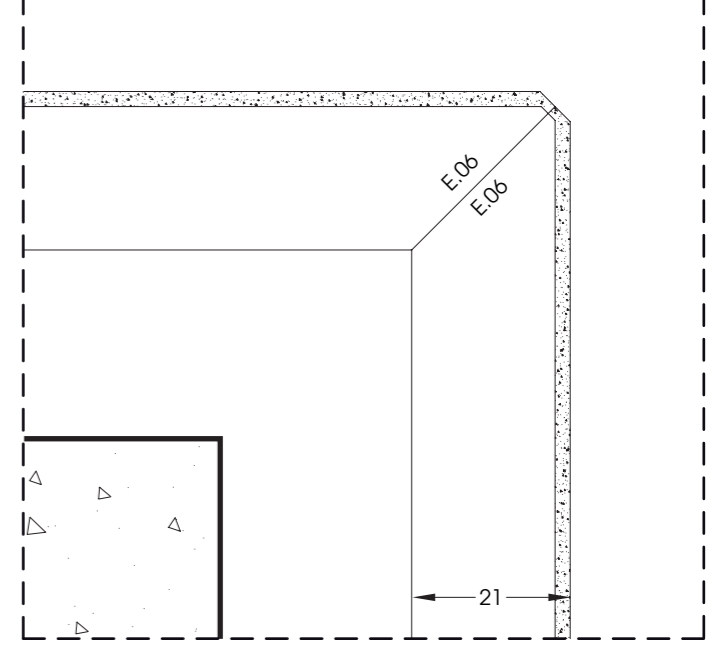

07 Protective Trim

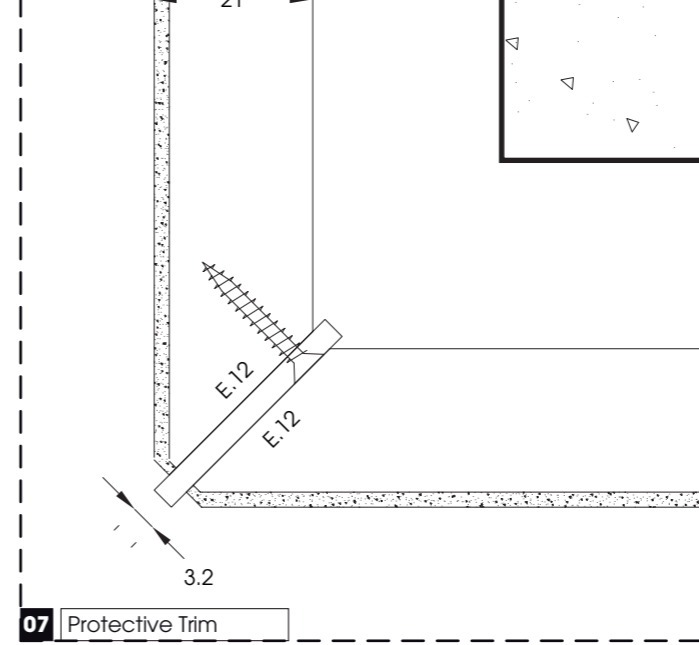

08 Trimmed Corner

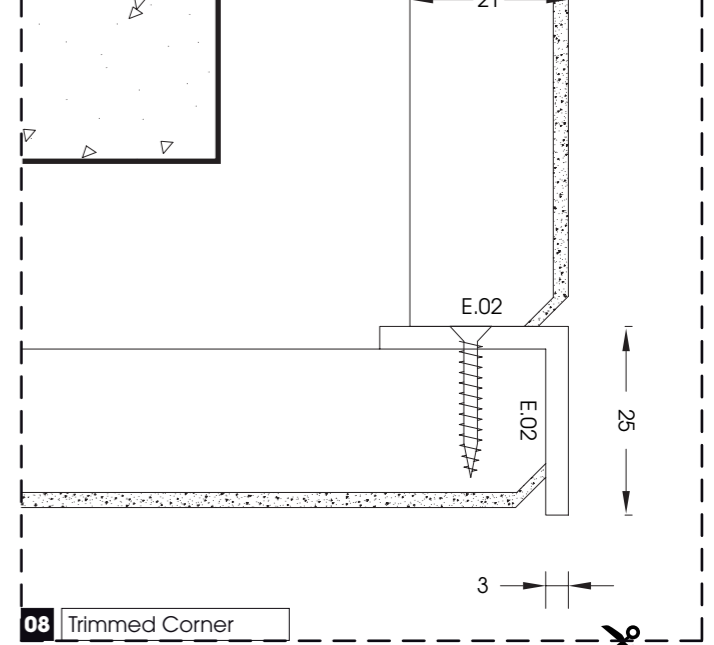

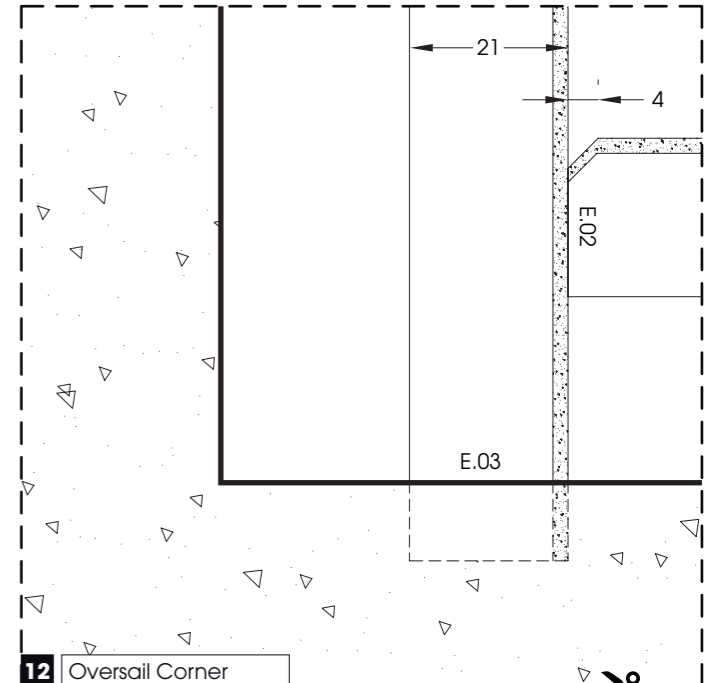
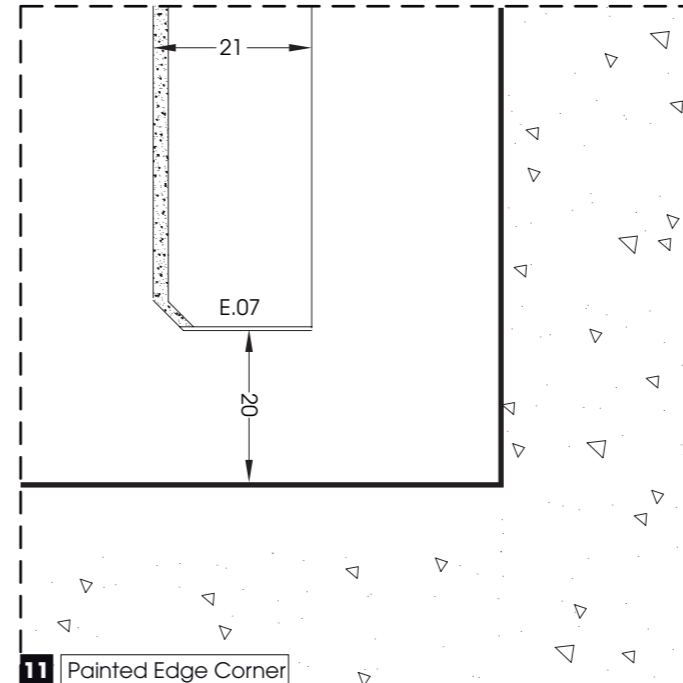
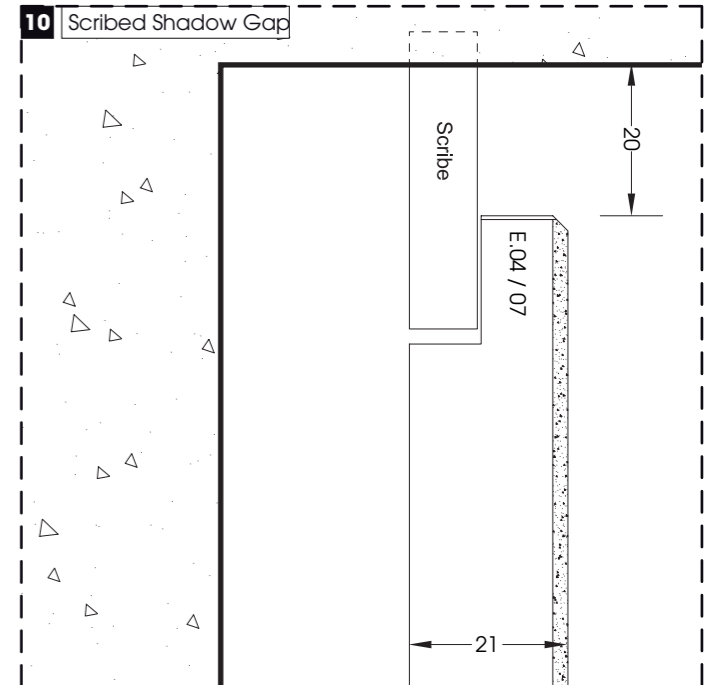
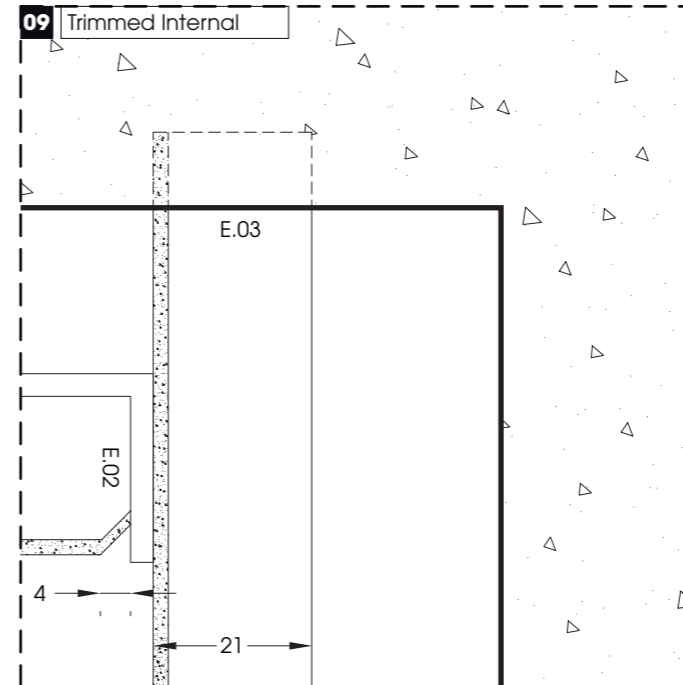

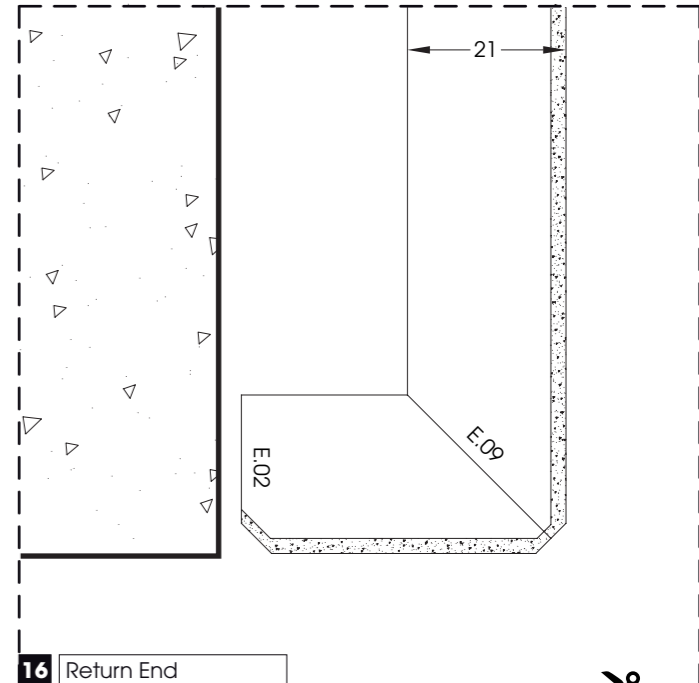
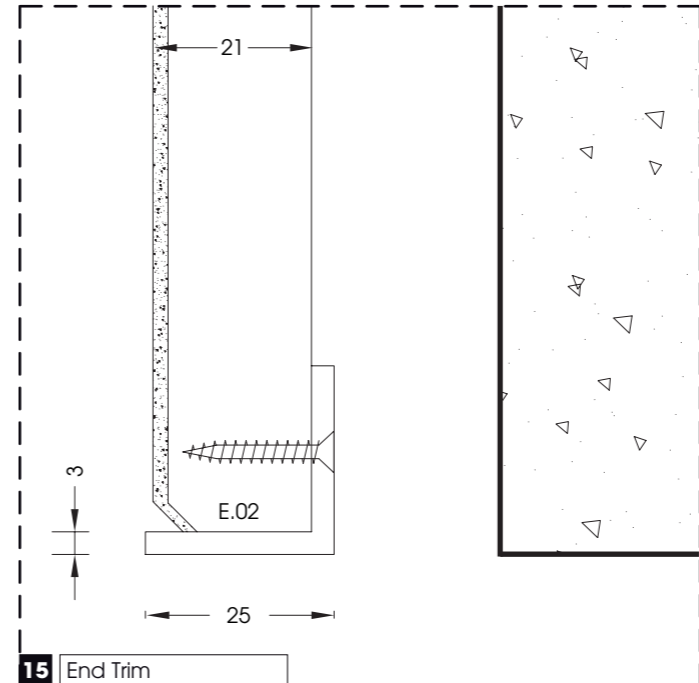
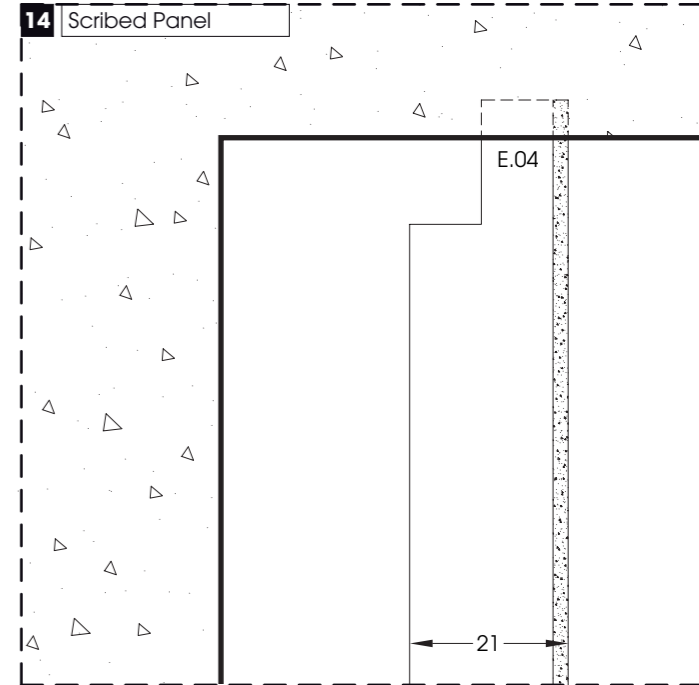
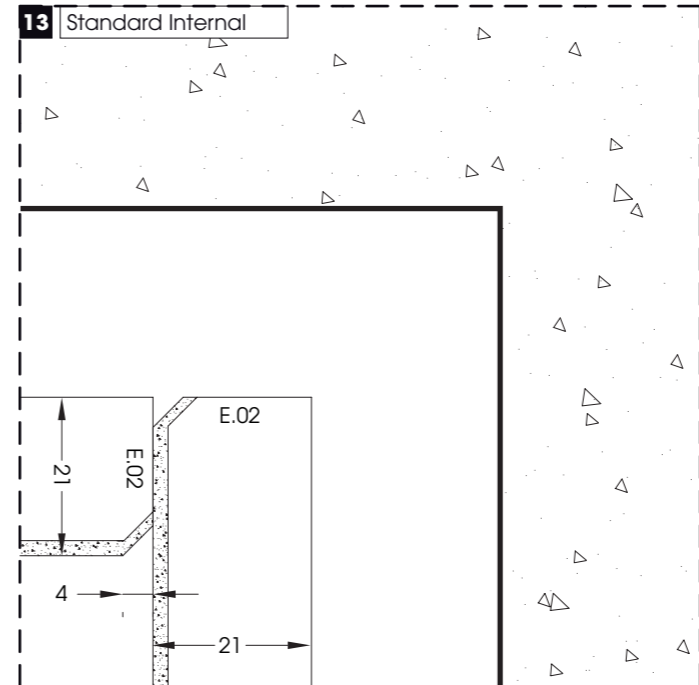

Build your external wall

Our FBC (fibre Cement) boards are suitable for external cladding. Note that this product must have a nominal gap at joints between panels.

Scale 1:1
Substrate: FBC

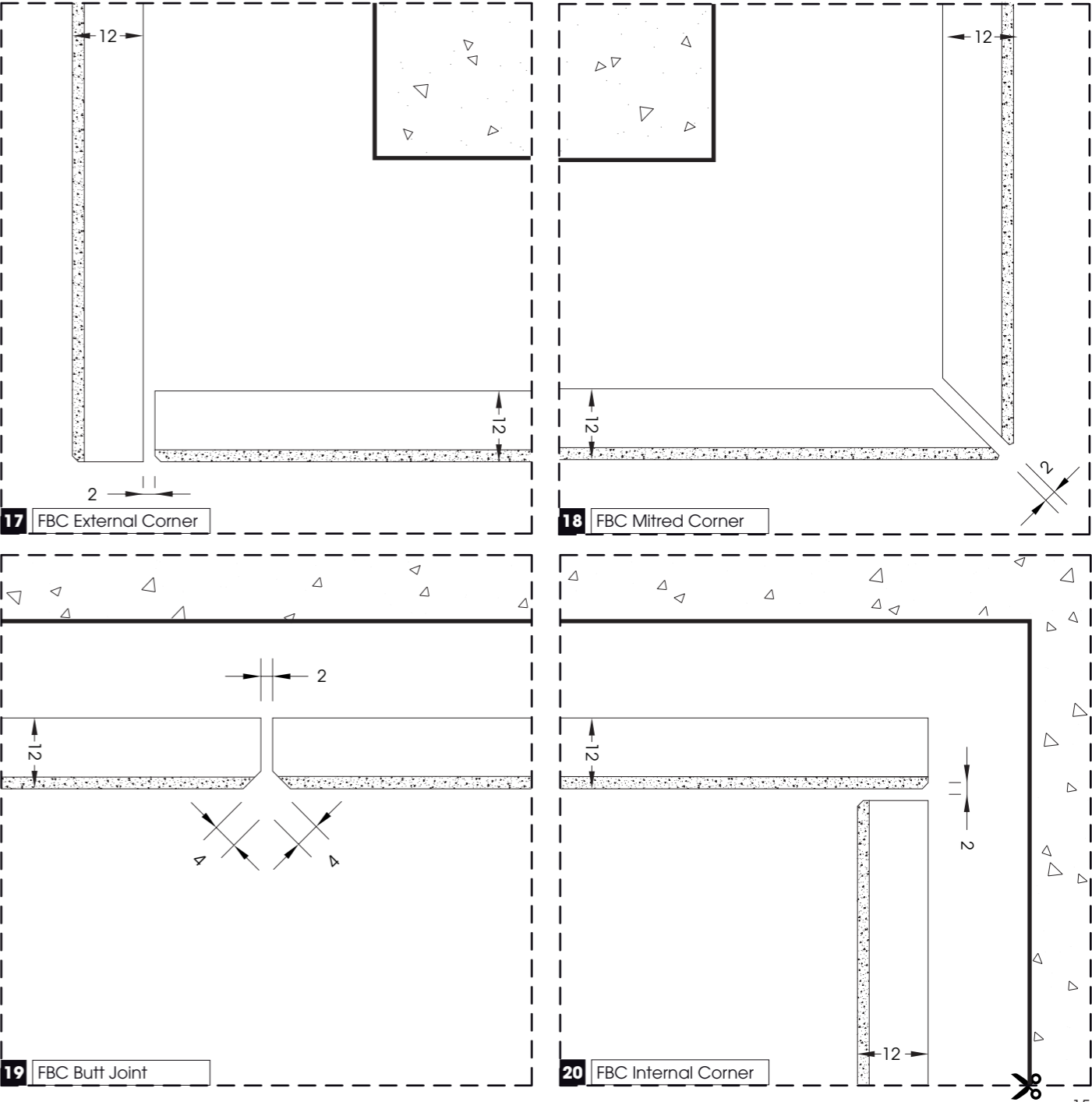

Cemento

8 Albemarle Way

Clerkenwell

London EC1V 4JB

+44(0)203 1464 100

www.cemento.co.uk

For further information please see:

Cemento Installation Guide

Cemento Technical Guide

Cemento Touch Up Guide